

INSTRUCTION MANUAL

IT IS RECOMMENDED THAT YOU READ THE FOLLOWING INSTRUCTIONS VERY CAREFULLY BEFORE USING THE PRODUCT. THE MANUFACTURER WILL NOT BE HELD RESPONSIBLE AND DECLINES ANY AND ALL LIABILITY FOR DAMAGE CAUSED TO PERSONS OR PROPERTY DUE TO IMPROPER USE WITH REFERENCE TO THE PRECAUTIONS OUTLINED IN THIS MANUAL.

THIS MANUAL MUST ALWAYS BE READILY AVAILABLE.

GENERAL PRECAUTIONS

- Do not use this product for any purpose other than that for which it was designed and as illustrated herein.
- After removing the product from the packing, make sure that it has not been damaged. If doubts arise, immediately contact professionally qualified personnel.
- Do not leave packing parts within the reach of children or unskilled people. Do not dump any hazardous parts into the environment (polystyrene, plastic, polypropylene, etc.).
- If the product is dropped or badly knocked, immediately contact qualified personnel (authorised dealer, service centre or manufacturer) to check that the product operates correctly.
- The use of any electrical device requires compliance with some basic rules which are listed below:
 - do not touch the device with moist or wet parts of the body (hands, feet).
 - this appliance is not intended for use by persons (including children) with reduced physical, sensory or mental capabilities, or lack of experience and knowledge, unless they have been given supervision or instruction concerning use of the appliance by a person responsible for their safety. Children should be supervised to ensure that they do not play with the appliance.
- Connect the product to the mains electricity supply or electrical outlet only if:
 - your electrical voltage and frequency corresponds to those shown on the rating plate.
 - the capacity of your electricity supply is sufficiently powerful to operate the product at its maximum power.If not, contact professionally qualified personnel.
- It is recommended that the product is switched off when not in use.
- Before carrying out any maintenance or cleaning, switch off the product and disconnect it from the mains electricity supply.
- If a fault, malfunction or anomaly of any type occurs, make the device inoperative (by turning off the switch and by disconnecting it from the mains electricity supply) and immediately contact qualified personnel.
Always request original spare parts to effect any repairs.
- If the product needs to be removed, turn off the main network circuit-breaker and then disconnect the device from that network. Place the device in a safe location far from children and/or unskilled people.
- The electricity system to which the product is connected must comply with the current standards regarding electrical systems (CEI 64-8, IEC 60364, HD 384) for the parts concerning the application of our devices.

SPECIAL PRECAUTIONS

- The product is professionally manufactured and complies with the current standards regarding electrical equipment.
- The product conforms with the EC directive EMC 2004/108 concerning the suppression of radio interference and electromagnetic compatibility.
- Do not place the device or relative parts in water or liquids, except where indicated in the cleaning and maintenance section.
- When cleaning or performing routine maintenance, check the condition of the device.
- To avoid the risk of fire, do not use the product in the presence of inflammable substances or vapours such as alcohol, insecticides, gasoline, etc.
- The air or fumes being extracted must be clean and free from greasy particles, soot, chemical and corrosive agents, inflammable or explosive mixes (If these substances are treated, contact an authorised dealer to consult the specific range of explosion-proof products).
- **The device must be installed and maintained by professionally qualified personnel.**
- The product must be connected to the electricity supply by means of a double-pole switch with a minimum contact opening distance higher than 3 mm.
- To ensure optimum operation, do not block the air intake and delivery vents.
- For devices operating in ducts, make sure that the duct is not blocked.
- The room where the device is located must be adequately ventilated to ensure correct operation.
- If the device is sited in a room containing a fuel burning appliance, the installer must ensure that air replacement is adequate both for the device and the fuel burning appliance.
- The device should not be used as an activator for water heaters, stoves, etc.
- The device must not exhaust into ducts designed to evacuate fumes coming from the combustion in stoves or other combustion-powered devices.
- The device must have a single duct (for its exclusive use) and it must be installed outdoor.

**THIS APPLIANCE IS PROVIDED WITH A NON SELF-RESETTING THERMAL CUT-OUT.
IN CASE SUCH DEVICE STARTS WORKING, IT CAN BE STARTED UP AGAIN, ONLY BY DISCONNECTING
THE APPLIANCE FROM THE MAIN ELECTRICITY SUPPLY.**

MODE OF INSTALLATION

APPLIANCES SHALL BE INSTALLED JUST BY DULY QUALIFIED PERSONS.

No appliance of this range weighs more than 20 kg, so that one-person alone can move them. For the weight of each item, please see Table 1.

While moving or installing the appliance, you shall wear gloves or similar protection means in order to prevent accidents for your own and third persons' safety.

Install your appliance according with Fig.1.

Fasten your appliance steadily by means of the supplied wall plugs.

Make reference to Fig 2 for the connection of the appliance.

Connection to the mains supply has to be done by means of a recessed wire.

Provide proper electric protections according to the installed model.

AS APPLIANCES ARE SHEET-MANUFACTURED (Class I), IT IS ABSOLUTELY IMPERATIVE THAT THEY ARE CONNECTED TO THE GROUND SYSTEM OR COLLECTOR ON THE INSTALLATION SPOT. 

When all the electric connection are carried out, check the connection terminals for their correct locking, close the external sheet case and start the appliance.

After the appliance has started, check whether:

- the rotation direction is correct.
- the electric absorption corresponds to the rating.
- excessive vibrations can compromise the appliance stability.

Should the appliance be connected through a regulator, make sure that said regulator is proportionate to the power of the concerning appliance.

FIG.1

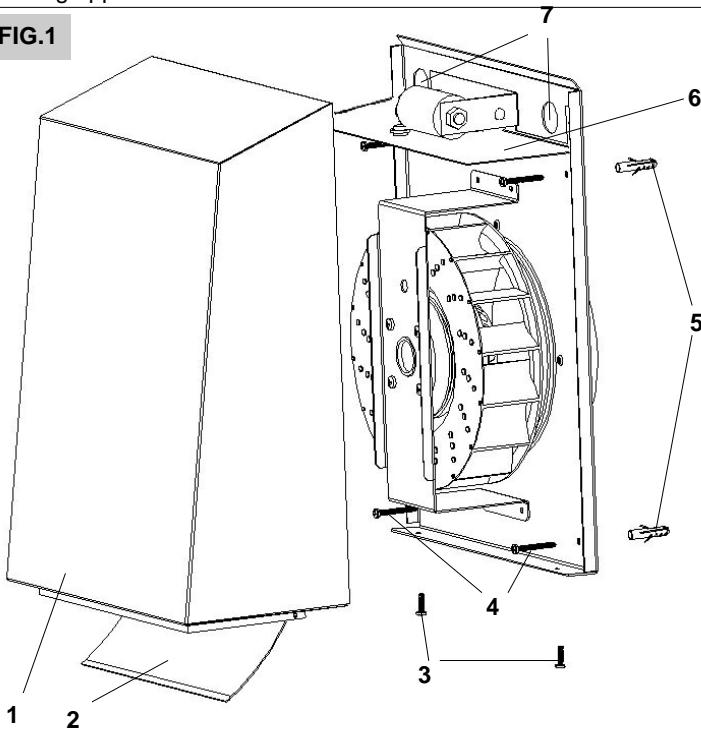

LEGEND FIG. 1

- 1 SHEET METAL CASE
- 2 FLAP
- 3 CASE FIXING SCREWS
- 4 WALL FIXING SCREWS
- 5 WALL PLUG
- 6 ELECTRICAL CONNECTION SUPPORT
- 7 CABLE ENTRY HOLE

TAB. 1

MODEL	A	B	Ød (mm)	C	D	Kg	Ta (°C)
EXT 100A	260	355	98	92	131	4,40	50
EXT 100B			98				60
EXT 150A			148				60
EXT 160A			157				60
EXT 150B	360	440	148	92	131	7,30	60
EXT 160B			157				60
EXT 200A			198				60
EXT 200B			198				70

CONNECTION FIG. 2

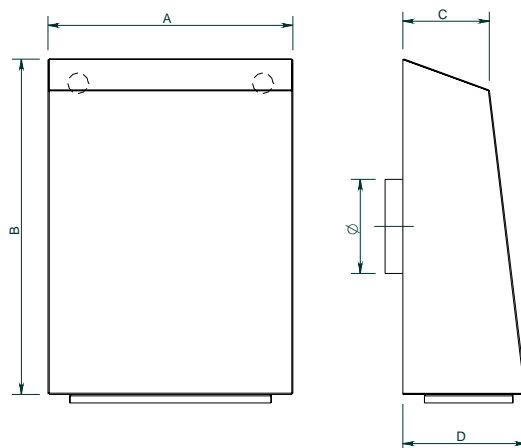
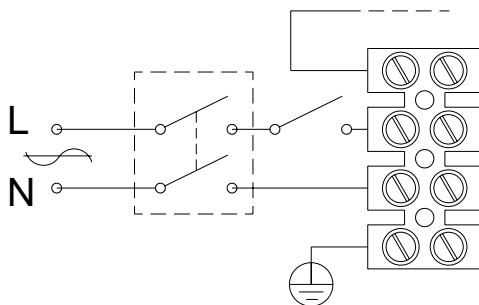

MAINTENANCE AND CLEANING

The appliance maintenance shall be carried out just by qualified persons.

The motor and the fan wheel shall be periodically controlled, according to the handled fluid and with the operation type; afterwards every six months of continuous operation.

Before any maintenance or cleaning operation, switch off the appliance by opening the master switch or the specific safety switch of the appliance.

During the normal cleaning operations, check the integrity of all appliance parts.